

APPENDIX-I_PTC LAB LAYOUT
All dimensions in Feet & inches (after decimal)

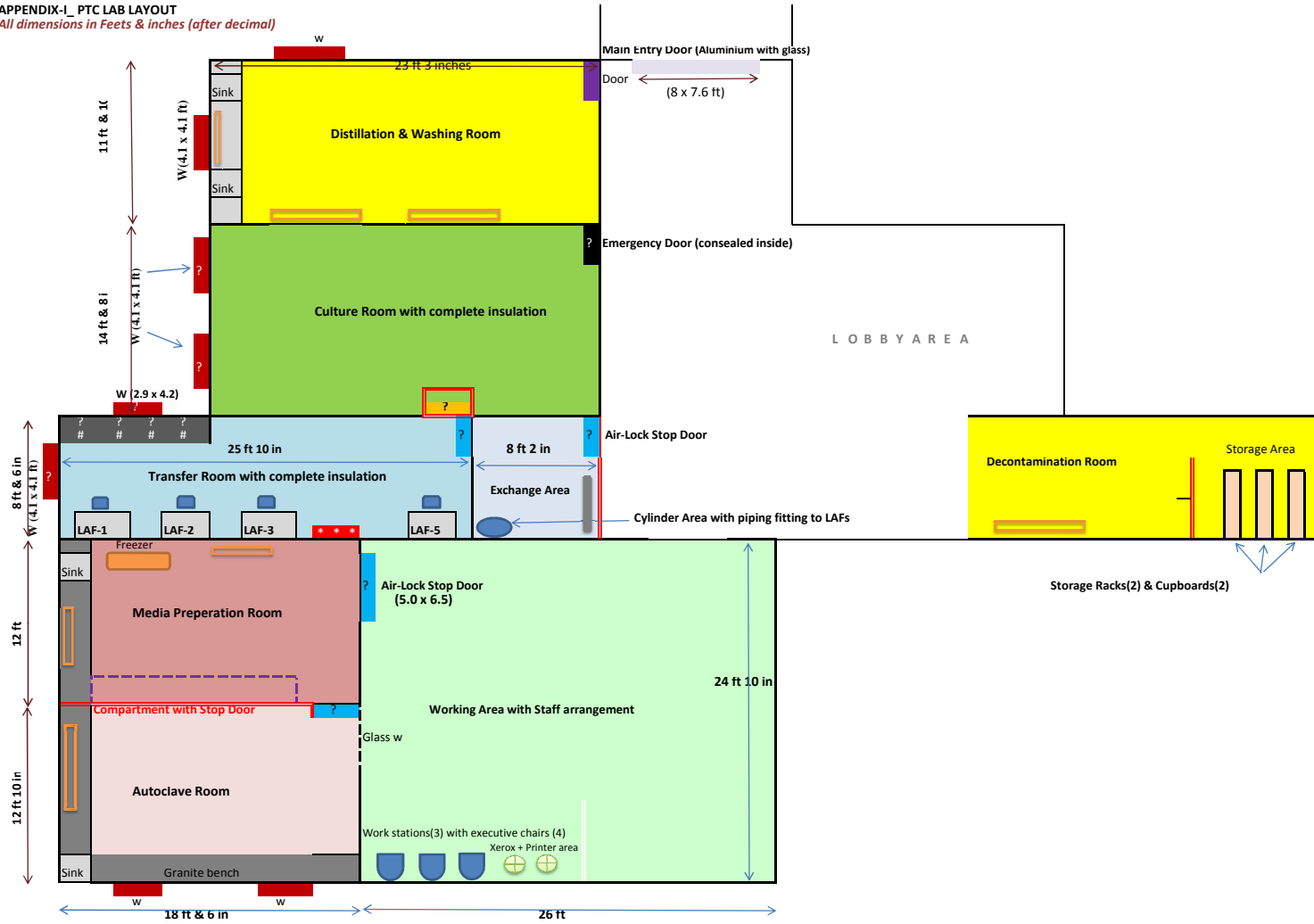

REQUIRMENTS: AS SHOWN ABOVE & ADDITIONAL (FURNISHING & OTHER RELATED WORKS) :

- Emergency Door
- Stop Door to be made with air-lock chamber (3 x 4 x 6)
- Stop Door (3.0 x 6.5)
- Windows to be sealed
- Compartment to be made with stop door
- Granite Bench for general working with racks (1) below
Length= 12 ft
Width= 1.5 ft
- Limited Access (Collapsible Air-tight Window) (2.5 x 3)
- Storage Racks in Media Room
- 5 Storage Wall mounted Racks with modulated panels (6 x 6 ft)
- Lab Chairs (12)
- Wardrobe like cupboard for apron-dressing clothes material

Not to Scale